

Torch heads DIX METZ 540/542/544/548

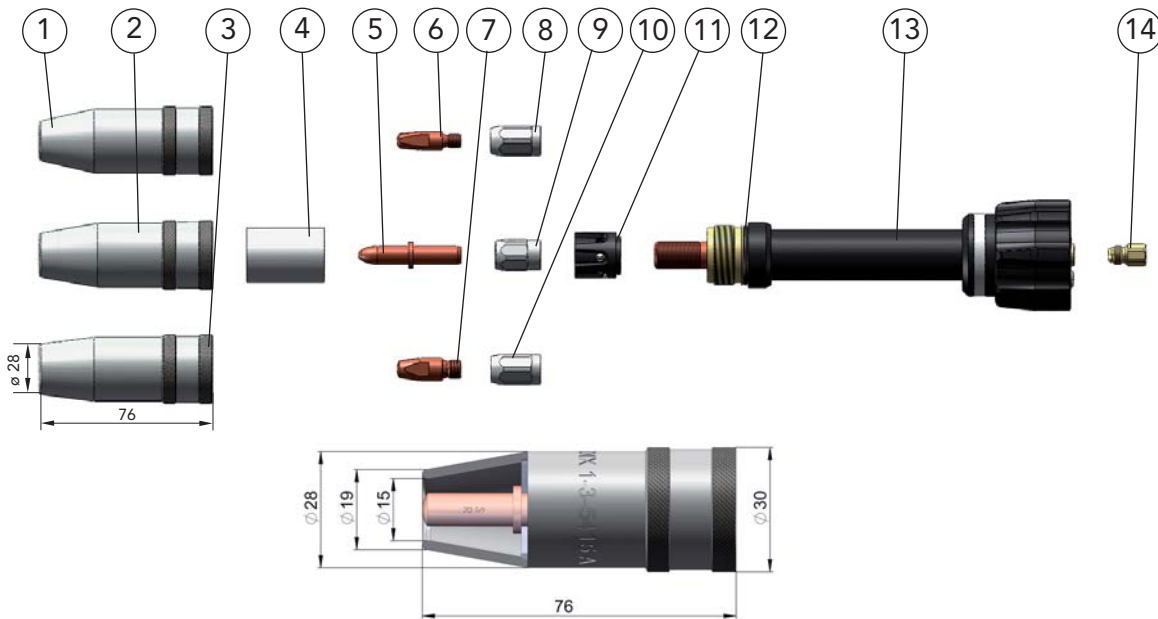

Description	Dimension	Part name	Part number
1 Gas nozzle	ID ø 13 mm	DIX 1-3-5413 A	6390154130
2 Gas nozzle	ID ø 15 mm	DIX 1-3-5415 A	6390154150
3 Gas nozzle	ID ø 18 mm	DIX 1-3-5418 A	6390154180
4 Insulator		DIX 2-3-500	6390250000
5 Contact tip	ø 8 x 45 mm	DIX 3-2-__ SR	6290354__
6 Contact tip	M6 x 24 mm	DIX 3-2-__	6290300__
7 Contact tip	M6 x 28 mm	DIX 3-2-__ CR-ZR	6290330__
8 Contact tip	M8 x 28 mm	DIX 3-2-__ M8	6290301__
9 Contact tip	M8 x 28 mm	DIX 3-2-__ M8 CR-ZR	6290331__
10 Tip adapter	M6	DIX GS 2 M6	628150006
11 Clamp nut		DIX 4-2-MAS	6390454000
12 Tip adapter	M8	DIX GS 2 M8	628150008
13 Gas diffusor		DIX 10-3-540	6391054000
14 O - ring	(10 pcs.)		639060003
15 Torch neck	0°	DIX 6-3-540 METZ	6390635400
16 Torch neck	22°	DIX 6-3-542 METZ	6390635420
17 Torch neck	45°	DIX 6-3-544 METZ	6390635440
18 Torch neck	30°	DIX 6-3-548 METZ	6390635480
19 Connecting piece		DIX MES 300/500	639061500041
20 Connecting piece, MEPTZ (without picture)		DIX MEPS 300/500	6390665000
21 Clamp sleeve (without picture)		DIX SH 270	629270270

__ Enter the required wire diameter, e.g.: 10 = 1.0 mm or 12 = 1.2 mm.

- Standard equipment for wire diameter 1.2 mm steel with gas nozzle diameter 15 mm, DIX 1-3-5415 A, (contact tip, DIX 3-2-1.2 S, flush, clamp nut DIX 4-2-MAS, Gas diffusor DIX 10-3-540). Use the hook spanner DIX SLAT 4 to fix the torch heads.

