

## Solenoid valve

EMVP 8 24V-DC 3/2 NC

Part no...:10.05.02.00164

<https://www.schmalz.com/10.05.02.00164>

Home > Vacuum Technology for Automation > Vacuum Components > Valve Technology > Solenoid Valves > Solenoid Valves EMVP > EMVP 8 24V-DC 3/2 NC

### Solenoid valve EMVP for vacuum, pneumatic pilot control



Nominal size: 8 mm

Voltage DC: 24V - DC

Function: 3/2-way valve

Control valve: Normally closed

Connecting thread: G1/4"-F

Nominal flow rate: 6 m<sup>3</sup>/h

Weight: 0.15 kg

### Design Data

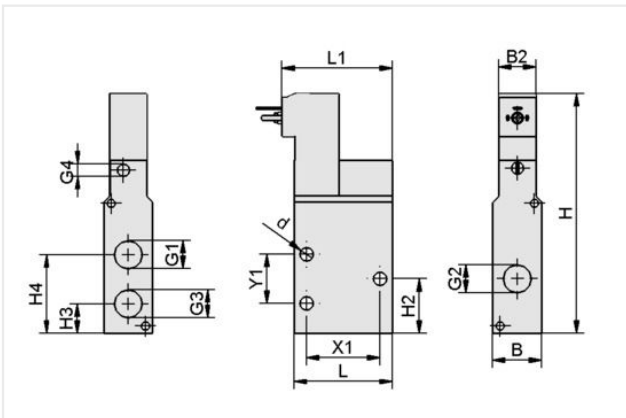

Attribute	Value
B	20 mm
B2	15.20 mm
d	5.50 mm
G1	G1/4"-F
G2	G1/4"-F
G3	G1/4"-F
G4	M5-F
H	112.80 mm
H2	22.20 mm
H3	12 mm
H4	32 mm
L	40 mm
L1	72 mm
X1	30 mm
Y1	20 mm

### Technical Data

Attribute	Value
Nominal size	8 mm
Nominal flow rate	6 m <sup>3</sup> /h

### Contact Schmalz

J. Schmalz GmbH | Johannes-Schmalz-Str.1, 72293 Glatten, Germany | +49 7443 2403-102 | [customercenter@schmalz.de](mailto:customercenter@schmalz.de)

## Solenoid valve

EMVP 8 24V-DC 3/2 NC

Part no...:10.05.02.00164

<https://www.schmalz.com/10.05.02.00164>

Control valve	Normally closed
Nominal flow rate	100 l/min
Power consumption DC	1 W
Voltage DC	24V - DC
Closing time	19 ms
Weight	0.15 kg
Product family	EMVP

### Accessories

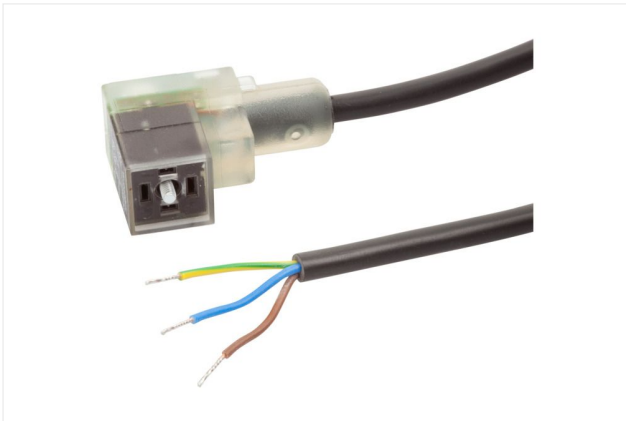

#### ASK B-Form-C 5000 K-3P

Part no...:21.04.06.00084

Electrical connection: Fem connect Form C

Cable length: 5,000 mm

Material hose: PVC cable