



## Capacitive Sensors

### Series 80 - PNP

Housing G 1/2"

- Housing material PTFE
- Sensing distance 0...3 mm adjustable
- With flange connector M 12 x 1

Certificate:



Technical data	Non-flush mountable
Operating distance $S_n$	1 mm
Operating distance min./max. adjustable	0...3 mm
Electrical version	4-pin DC
Output	Antivalent (NO+NC)
Type NPN	
Art.-No.	
Connection diagram No..	
Type PNP	KAS-80-G1/2"-A-K-PTFE-Y3-G-NL
Art.-No.	KA 0624
Connection diagram No.	6
Operating voltage ( $U_B$ )	12...30 V DC
Output current max. ( $I_o$ )	2 x 200 mA
Load current min.	-
Voltage drop max. ( $U_d$ )	$\leq 2.0$ V
Permitted residual ripple max.	10%
No-load current ( $I_o$ )	Typ. 15 mA
Frequency of operating cycles max.	50 Hz
Permitted ambient temperature	0...+70° C
LED-display	Yellow
Protective circuit	Built-in
Degree of protection IEC 60529	IP 67
Norm	EN 60947-5-2
Connection	Flange connector M 12 x 1
Housing material	PTFE
Active surface	PTFE
Lid	-

All specifications are subject to change without notice. (15.08.2007)

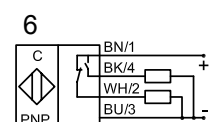
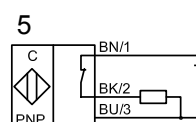
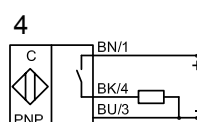
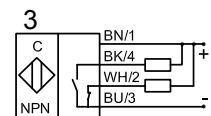
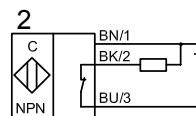
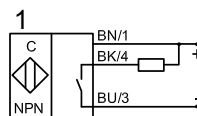
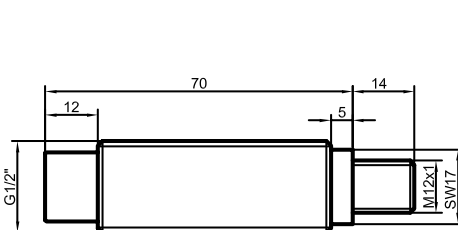

**Made in Germany**