

Hydraulic lock nut D109/DK109

With clamping pressure indicator,
hydraulic retract

POLYMA-THEKA

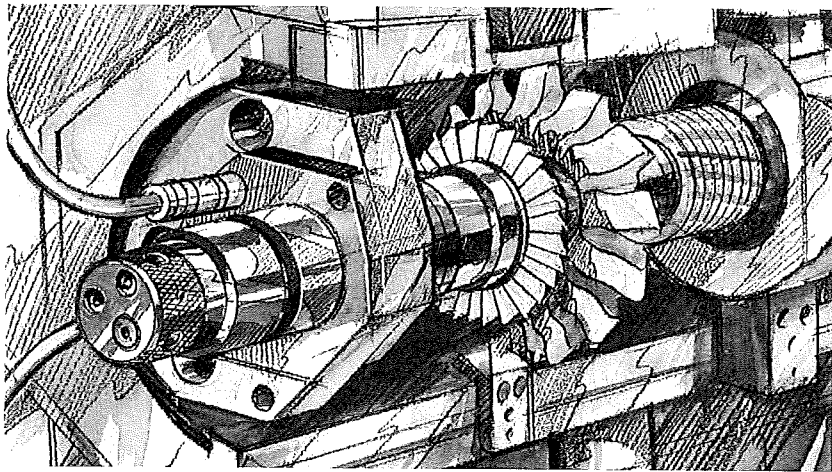

Developed together with GLEASON-PFAUTER for the clamping of the hob cutters it is part of their work standard under number WN41023.

Its outside diameter makes it possible to draw the outer boring over the lock nut so that the cutter arbor with preset hobbing cutters can be changed in spite of the outer bearing being inside.

Screw on the lock nut hand-tight. The actuation of the fully enclosed hydraulic system is effected by tightening the screw on the front. The height of the effective

more axial clamping depends on the cutter arbor and is supervised by the clamping pressure indicator. The clamping pressure is reached as soon as the red ring indicator pin reaches the height of the golden insert. There exist no transverse forces causing a shifting on the hobbing cutter.

The reset of the lock nut with a pressure up to 120 kN (26400 lbs) is manually effected with the internal screw thread.

For machines having a big outer bearing (arbor thread M42x1,5LH) the lock nut DK109-A300 is equipped with hydraulic resets. This makes operation easier and safer, as with the release, the hydraulics automatically return to zero/initial position.

For the power of supply an Allen wrench is needed. Big wrenches or wrench extensions are no longer used.

THEKA

POLYMA

Hydraulic lock nut D109/DK109

With clamping pressure indicator,
hydraulic retract

POLYMA-THEKA

**ALBERT SCHREM
Werkzeugfabrik GmbH**

Ulmer Straße 56 · D-89537 Giengen/Brenz

PO Box 1504 · D-89530 Giengen/Brenz

Telephone +49 (0) 73 22-60 06 · Telefax +49 (0) 73 22-60 08

info@schrem-tools.com · www.schrem-tools.com

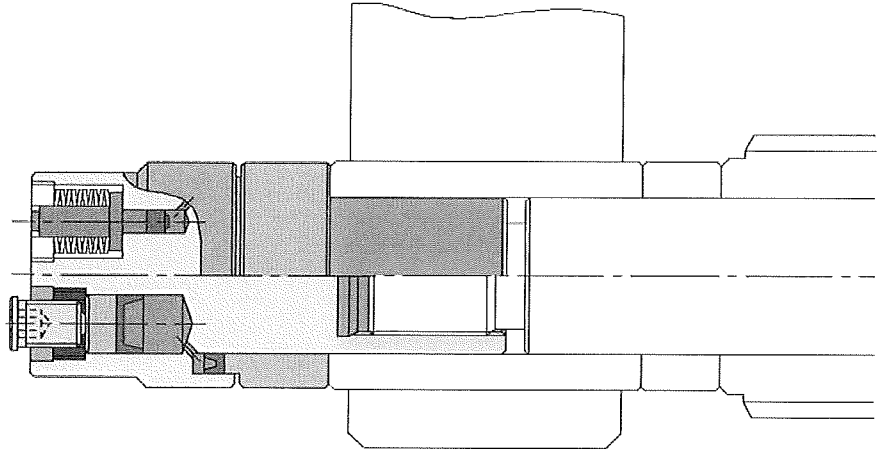

Technical Data

Please specify thread when ordering.

Order No.	Arbor diameter to		Max. clamping force kN	Marked ring	Pressure indicator Clamping force	
	mm	inch			kN	lbs
D109-A020	12	0.500	20	1	20	4400
D109-A060	16	0.625	60	1	60	13200
D109-A080	20	0.750	80	1	80	17600
D109-A100	24	0.875	100	1	100	22000
D109-A120	30	1.125	120	1	120	26400
DK109-A300	42	1.625	300	1	300	66000

Dimensions

Order No.	Dimensions (mm)								
	Ø D	Ø d ₁	Ø d ₂	Ø d ₃	L	L ₁	L ₂	L ₃	L ₄ *
D109-A020	to 12	57,5	52	40	117	77	27	38	5
D109-A060	to 16	57,5	52	40	117	77	27	38	5
D109-A080	to 20	57,5	52	40	117	77	27	38	5
D109-A100	to 24	57,5	52	40	117	77	27	38	5
D109-A120	to 30	57,5	52	40	117	77	27	38	5
DK109-A300	to 42	81,5	76	60	150	94	36	54	0

*L₄ = untied screw

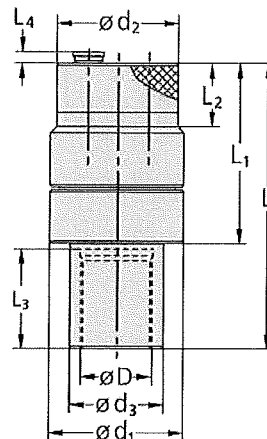

Subject to technical alterations