

Torch heads DIX MET 3200/3222/3245

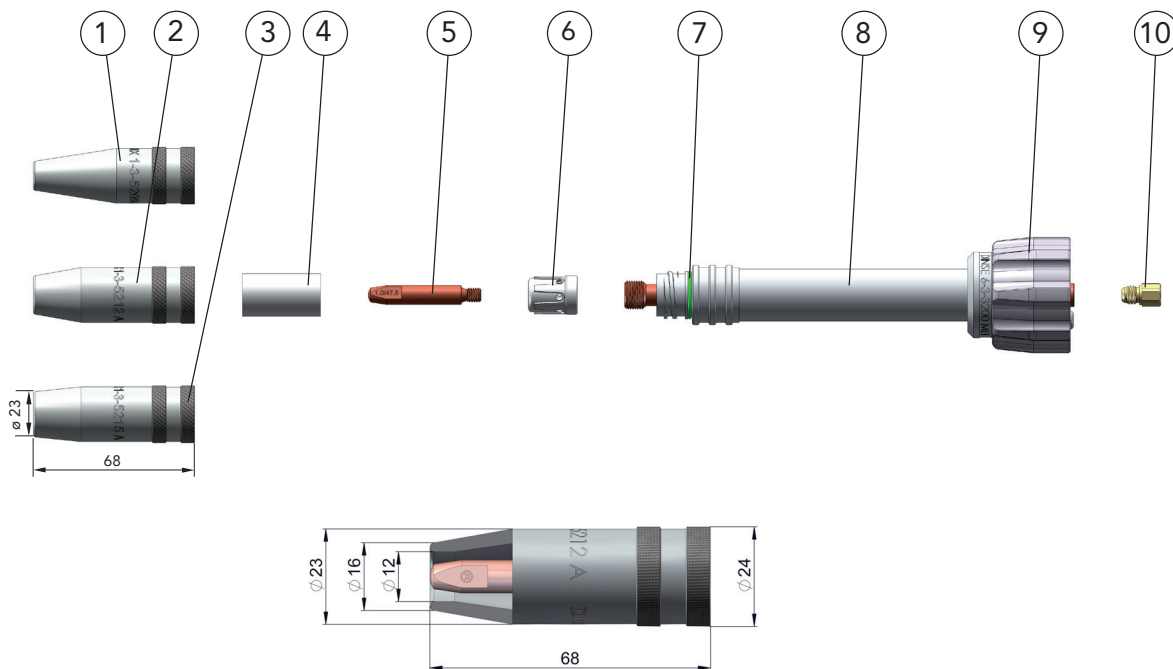

Description	Dimension	Part name	Part number
1 Gas nozzle	ID \varnothing 9 mm	DIX 1-3-5209 A	6390152090
2 Gas nozzle	ID \varnothing 12 mm	DIX 1-3-5212 A	6390152120
3 Gas nozzle	ID \varnothing 15 mm	DIX 1-3-5215 A	6390152150
4 Insulator		DIX 2-3-520	6390252000
5 Contact tip	M6 x 47.5 mm	DIX 3-2-__/_/47.5	6290342__
6 Gas diffuser	(10 pcs.)	DIX GVT 3200 K	6391052001
7 O-Ring (Viton)	(10 pcs.)		639060004
8 Torch neck	0°	DIX 6-3-3200 MET	6390653200
Torch neck	22°	DIX 6-3-3222 MET	6390653222
Torch neck	45°	DIX 6-3-3245 MET	6390653245
9 Screw cap, gray		DIX 6-3 MET	629061001
10 Connecting piece		DIX MES 300/500	639061500041
Connecting piece, MEPTZ (without picture)		DIX MEPS 300/500	6390665000
Clamp sleeve (without picture)		DIX SH 270	629270270

-- Enter the required wire diameter, e.g.: 10 = 1.0 mm or 12 = 1.2 mm.

- Standard equipment for wire diameter 1.0 mm steel with gas nozzle diameter 12 mm, DIX 1-3-5212 A, (contact tip, DIX 3-2-1.2/47.5, flush, Gas diffuser DIX GVT 3200 K). Use the hook spanner DIX SLAT 4 to fix the torch heads.