

### TYPE TA

#### Features

- Manufactured from high strength 6061-T6 aluminum alloy
- Electro-tin plated
- Chamfered wire entry
- Suitable for use in circuits rated 35KV or less, proper high voltage spacing and insulation techniques must be used
- Rated to 90° C

#### Benefits

- Suitable for use with either copper or aluminum conductors
- Provides low contact resistance
- Provides ease of installation
- Application versatility

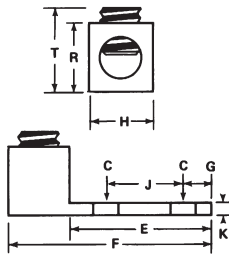

Fig. 1



Fig. 2



Fig. 3



Fig. 4



Fig. 5

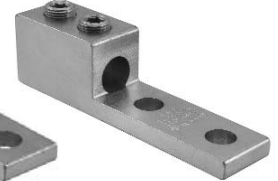

Fig. 6

Catalog Number	Figure Number	Wire Range	Bolt Size	Dimensions										Hex Size
				C	E	F	G	H	J	K	R	T		
TA-6-S	1	4-14	1/4	17/64	11/16	1-1/16	1/4	1/2	-	3/32	1/2	41/64	S	
TA-2	1	One: 2-14 Two: 10-14 CU 10-12 AL	1/4	17/64	11/16	1-5/32	5/16	1/2	-	7/64	9/16	3/4	S	
TA-0	1	One: 1/0-14 Two: 4-12	1/4	17/64	27/32	1-15/32	7/16	5/8	-	3/16	25/32	29/32	S	
TA-2/0	2	2/0-14	1/4	17/64	27/32	1-15/32	7/16	5/8	-	3/16	25/32	1-1/32	3/16	
TA-250	2	250kcmil-6	5/16	21/64	1	2	15/32	1	-	1/4	1-1/8	1-21/64	5/16	
TA-300	2	300kcmil-6	1/4	9/32	1	2	1/2	55/64	-	1/4	1-1/8	1-11/32	5/16	
TA-350	2	350kcmil-6	3/8	13/32	1-1/8	2-1/4	1/2	1-1/8	-	1/4	1-1/4	1-29/64	3/8	
TA-500	2	500kcmil-4	3/8	13/32	1-19/32	2-13/16	7/8	1-1/2	-	5/16	1-13/16	1-13/16	3/8	
TA-500-S	3	One: 600kcmil-4 Two: 250kcmil-1/0*	3/8	13/32	1-1/2	2-13/16	5/8	1-5/16	-	5/16	1-13/16	2-3/16	1/2	
TA-600	2	600kcmil-2	3/8	13/32	1-13/16	3-3/16	7/8	1-1/2	-	7/16	1-9/16	1-31/32	1/2	
TA-800	2	800kcmil-300kcmil	5/8	21/32	1-3/4	3-3/8	7/8	1-3/4	-	1/2	1-15/16	2-15/64	1/2	
TA-800-S	4	800kcmil-3/0	5/8	21/32	1-3/4	3-1/4	11/16	1-5/16	-	1/2	1-13/16	2-3/16	1/2	
TA-1000	2	1000kcmil-350kcmil	5/8	21/32	1-3/4	3-3/8	7/8	1-3/4	-	1/2	1-15/16	2-25/64	9/16	
TA-1000-S	4	1000kcmil-500kcmil	5/8	21/32	1-3/4	3-1/4	11/16	1-7/16	-	1/2	1-13/16	2-3/16	9/16	
TA-350-2NS	5	350kcmil-6	1/2	9/16	3	4-5/16	5/8	1-1/8	1-3/4	5/16	1-3/8	1-29/64	3/8	
TA-600-2NS	5	600kcmil-2	1/2	9/16	3-5/16	4-11/16	5/8	1-1/2	1-3/4	7/16	1-3/8	1-59/64	1/2	
TA-800-2NS	5	800kcmil-300kcmil	1/2	9/16	3-1/8	4-3/4	5/8	1-3/4	1-3/4	1/2	1-15/16	2-3/16	1/2	
TA-1000-2NS	5	1000kcmil-500kcmil	1/2	9/16	3-1/8	4-3/4	5/8	1-3/4	1-3/4	1/2	1-15/16	2-27/64	9/16	
TA-350-2N	6	350kcmil-6	1/2	9/16	3-1/4	5-1/2	5/8	1-1/4	1-3/4	3/8	1-1/2	1-21/32	(2)3/8	
TA-600-2N	6	600kcmil-2	1/2	9/16	3-1/4	5-1/2	5/8	1-3/8	1-3/4	3/8	1-1/2	1-31/32	(2)3/8	
TA-800-2N	6	800kcmil-300kcmil	1/2	9/16	3-5/8	5.97	5/8	1-1/2	1-3/4	1/2	1.813	2-15/64	(2)1/2	
TA-1000-2N	6	1000kcmil-350kcmil	1/2	9/16	3-5/8	5.97	5/8	1-5/8	1-3/4	1/2	1.813	2-25/64	(2)1/2	

All wire sizes, unless noted otherwise, are American Wire Gauge (AWG)

DE-OX Inhibitor is recommended for all aluminum terminations.

\* Parallel wires must be identical

Tested to UL 486A/B, UL File E6207