

Timer type 726 014 000

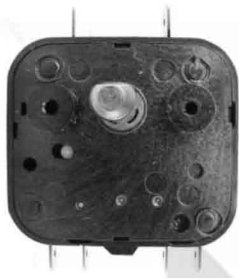

15 minute, 6 horizontal contacts, hold function
Mounted with two screws 2,9x8

Applications: *Battery chargers, ultrasonic cleaners, saunas, tanning beds, medical equipment, dryers, small appliances, and food service equipment.

Standard Features: * max 16 A (active power) and 3 A (for reactive (inductive) power) – 240 V
* max 10 A (active power) 2 A (for reactive (inductive) power) – 400 V
* 1/4 HP 120/250 Vac 60Hz

Certificates: * VDE, ENEC, CSA, UL

MOUNTING FOR TIMER

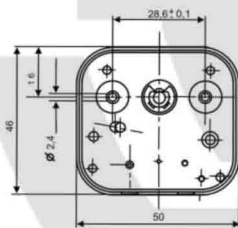

TYPE OF COVER

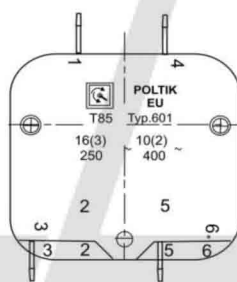

TURNING ANGLE

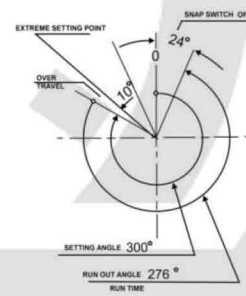

TYPE OF SWITCH

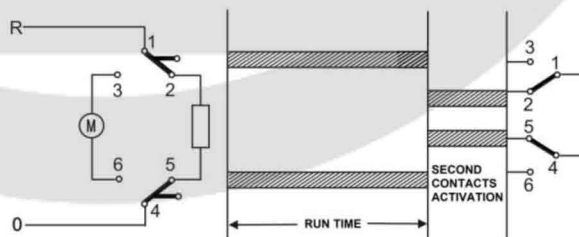

SHAPE OF SHAFT

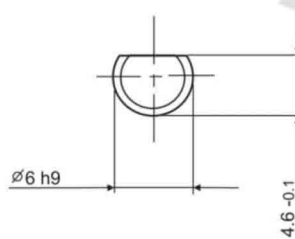

POSITION "0"

