

Glass Filler Plumbing Kit

Part Number 98498C

This plumbing kit is designed to be used with Elkay pressure coolers.

Warning

To avoid risk of electrical shock, personal injury or death, disconnect from electrical power supply and shutoff water supply before installing this plumbing kit.

Caution

To avoid property damage, personal injury and voiding your warranty:

- Have this kit installed by an authorized person. (Installation person should be familiar with water cooler plumbing, refrigeration systems and general plumbing practices.)
- Install this kit into a Elkay model pressure cooler.
- Make sure you read, understand and follow the instructions.
- Wear hand and arm protection. Use caution when working inside the water cooler. Edges inside the water cooler can be sharp.
- Wear eye safety goggles.

Required Tools

To install this kit the following tools are required:

- Phillips Screwdriver
- Needle Nose Pliers
- 1/4" and 5/16" Nut or Socket Driver
- Tubing Cutter (Mini)
- 11/16" (.687") diameter hole punch or drill bit.
- Large adjustable wrench.
- T-20 and/or T25 Pinned Torx Driver

Parts List

Refer to the illustration to make sure you receive all plumbing kit parts. If any parts are missing contact your Elkay parts distributor. Depending on model, not all parts are required.

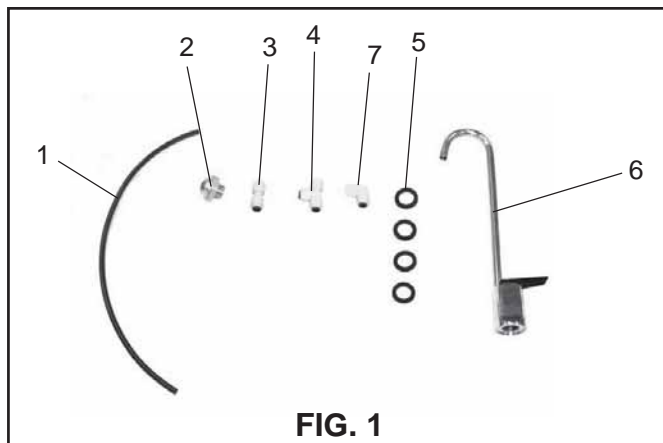

ITEM NO.	PART NO.	DESCRIPTION
1	56092C	Poly-Tubing (Cut to Length)
2	15009C	Glass Filler Nipple
3	70683C	Connector 1/4" Tubing
4	70682C	Tee 1/4" Tubing
5	100322740560	Gasket (4 Supplied with kit)
6	75630C	Glass Filler
7	70817C	Elbow 1/4 Tubing

Operation of Quick Connect Water Fittings:

Cooler is provided with lead-free connectors which utilize an "O"-ring water seal. To remove tubing from the fitting, relieve water pressure, push in on the darker gray collar before pulling on the tubing. To insert tubing, push tube straight into fitting until it reaches a positive stop, approximately 3/4" (19mm). Deburr cut tube ends before inserting into the Quick Connect Fitting. Burrs on the tube end will cut the internal "O"-Ring and will allow the fitting to leak.

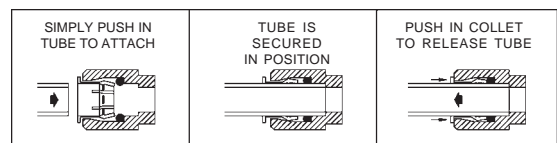

PUSHING TUBE IN BEFORE PULLING IT OUT HELPS TO RELEASE TUBE

Overview

The following illustration shows the tube routing before and after the installation of the Glass Filler Kit.

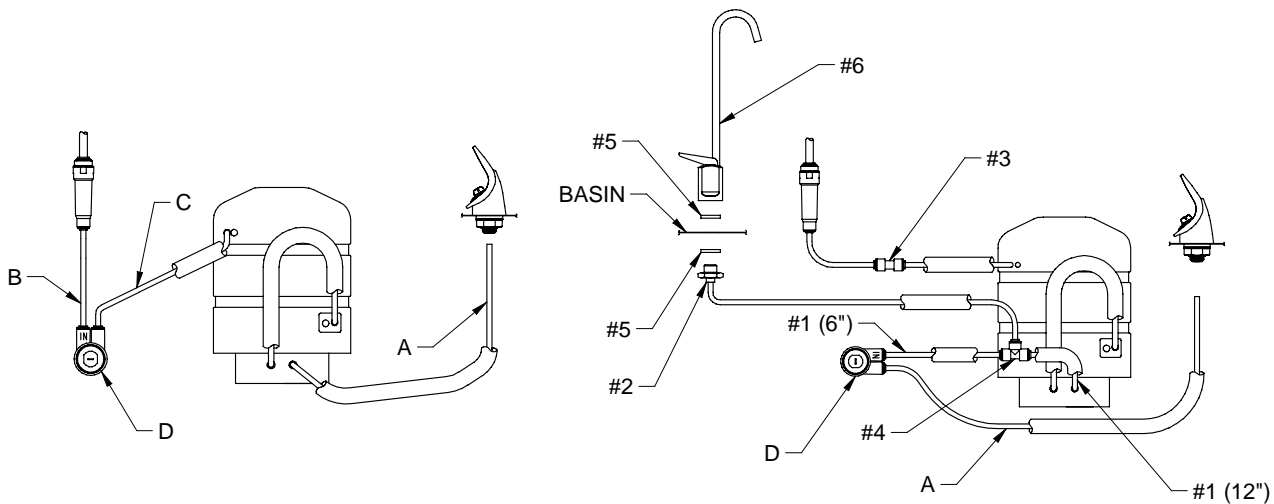

Before (Non-Pressurized Tank)

After (Pressurized Tank)

The water storage tank must be converted to a pressurized tank for the glass filler to operate properly. The tank is non-pressurized in a standard unit. The following steps detail how the water flow tubing is re-routed to create a pressurized tank and provide a supply line to the glass filler.

Note: Item numbers in the following steps refer to items in Parts List on page 1.

STEP 1

Remove Cooler Basin

- Remove lower front panel.
 - Disconnect cooler from electrical supply.
 - Turn off water supply to unit.
 - Remove basin screws (4 each side, 8 total).
 - If cooler is installed remove strainer and drain plug or disconnect unit from trap.
- Lift front of basin and disconnect bubbler tube (A) from bubbler.
 - Refer to details "Operation of Quick Connect Fittings" for removing tubes.
- Remove cooler basin.

STEP 2

- Remove glass filler plug from basin or drill or punch an 11/16" (.687") diameter hole in the cooler basin where desired. Note: Tube length may vary depending upon glass filler location, if the hole HAS NOT been prepunched by the factory.

STEP 3

Cut and Remove Internal Plumbing

- Remove tank to bubbler tube (A).
 - Disconnect bubbler tube at chilled tank water outlet.
 - Save the tube. This will be used in step 4.
- Cut supply tubes at locations (B) and (C).
- Remove and discard bent tubes from water regulator (D).
 - Refer to details "Operation of Quick Connect Fittings" for removing tubes.

STEP 4

Reconnect Internal Plumbing

- Connect water inlet line to chiller inlet.
 - Using union (Item 3) reconnect tubes cut at (B) and (C) in step 3.
- Connect chiller outlet to tee.
 - Cut a 12 inch long piece of tube (Item 1). Install into the chiller water outlet. Connect end to tee (Item 4).
- Connect tee to regulator and glass filler supply tube.
 - Cut a 6 inch long piece of tube (Item 1).
 - Connect one end of tube to tee (Item 4) and other end to water regulator inlet (D).
 - Cut a 12 inch long piece of tube (Item 1).
 - Connect to tee (Item 4) and to Glass Filler Nipple (Item 2).
- Connect bubbler tube to regulator.
 - Use tank to bubbler tube, removed in Step 3, cut length of tube to 10 inches and connect to regulator outlet.

STEP 5

Reassemble Unit

- Connect Glass Filler to basin.
 - Using one gasket (Item 5) below the basin and one gasket (Item 5) above the basin assemble the glass filler (Item 6) to the basin.
- Reassemble the unit and leak check.
 - Assemble basin to the unit. Reattach with screws removed in Step 1.
 - Reassemble drain components.
 - Turn on water supply. Run water through bubbler and glass filler. Check all connections for water leaks.
 - Reconnect electrical supply.
 - Replace panels.